

Fuel Level Sender

Single Overhead Camshaft (SOHC) and 4.6L (3V) Vehicles

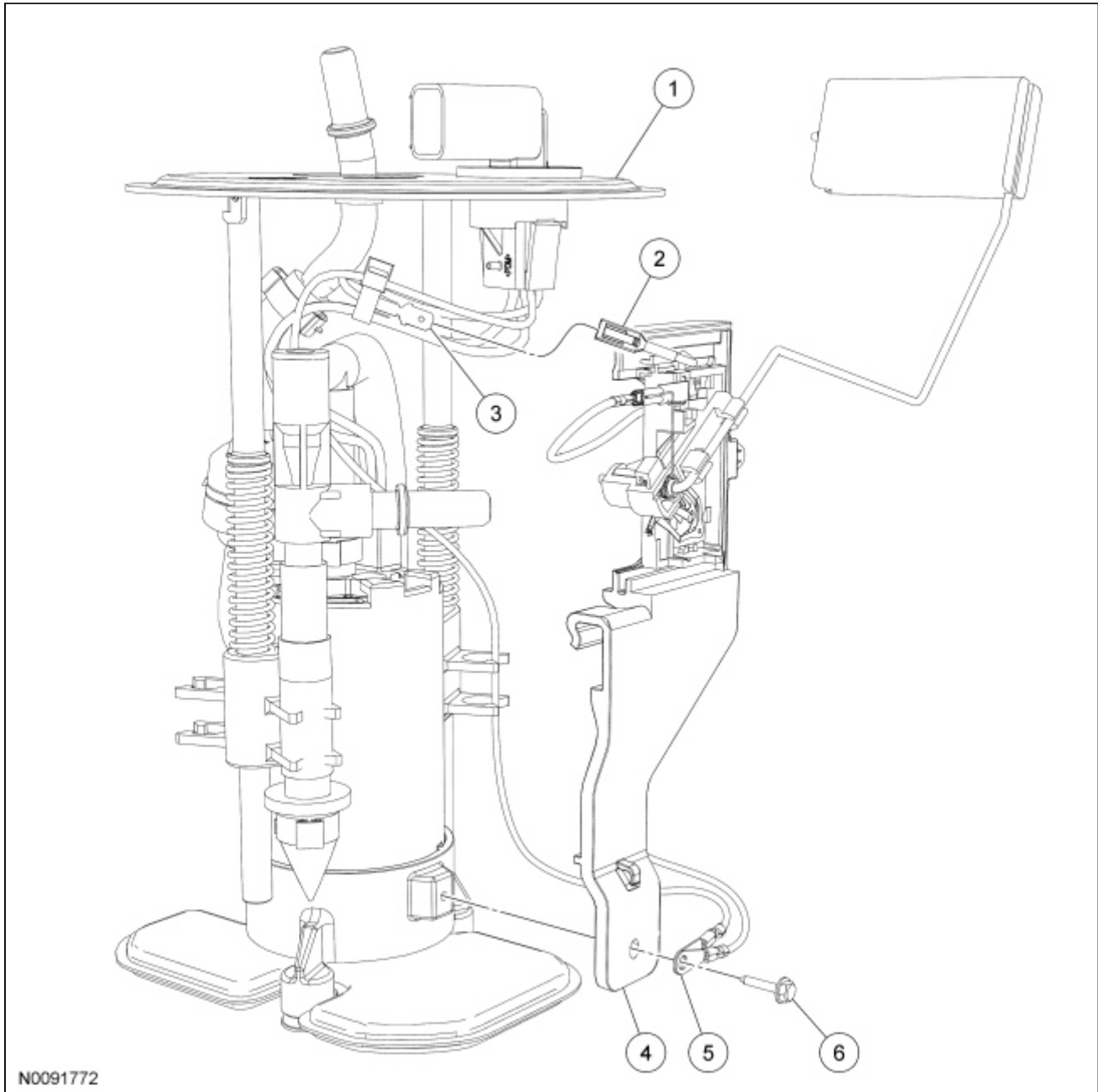

N0091772

Item	Part Number	Description
1	9H307	Fuel Pump (FP) module
2	—	Fuel level sender electrical connector (part of 9A299)
3	—	Fuel level sender electrical connector (part of 9H307)
4	9A299	Fuel level sender
5	—	Fuel level sender electrical connector eyelets (part of 9A299 and 9H307)
6	—	Fuel level sender screw (part of 9H307)

5.4L (4V) Vehicles

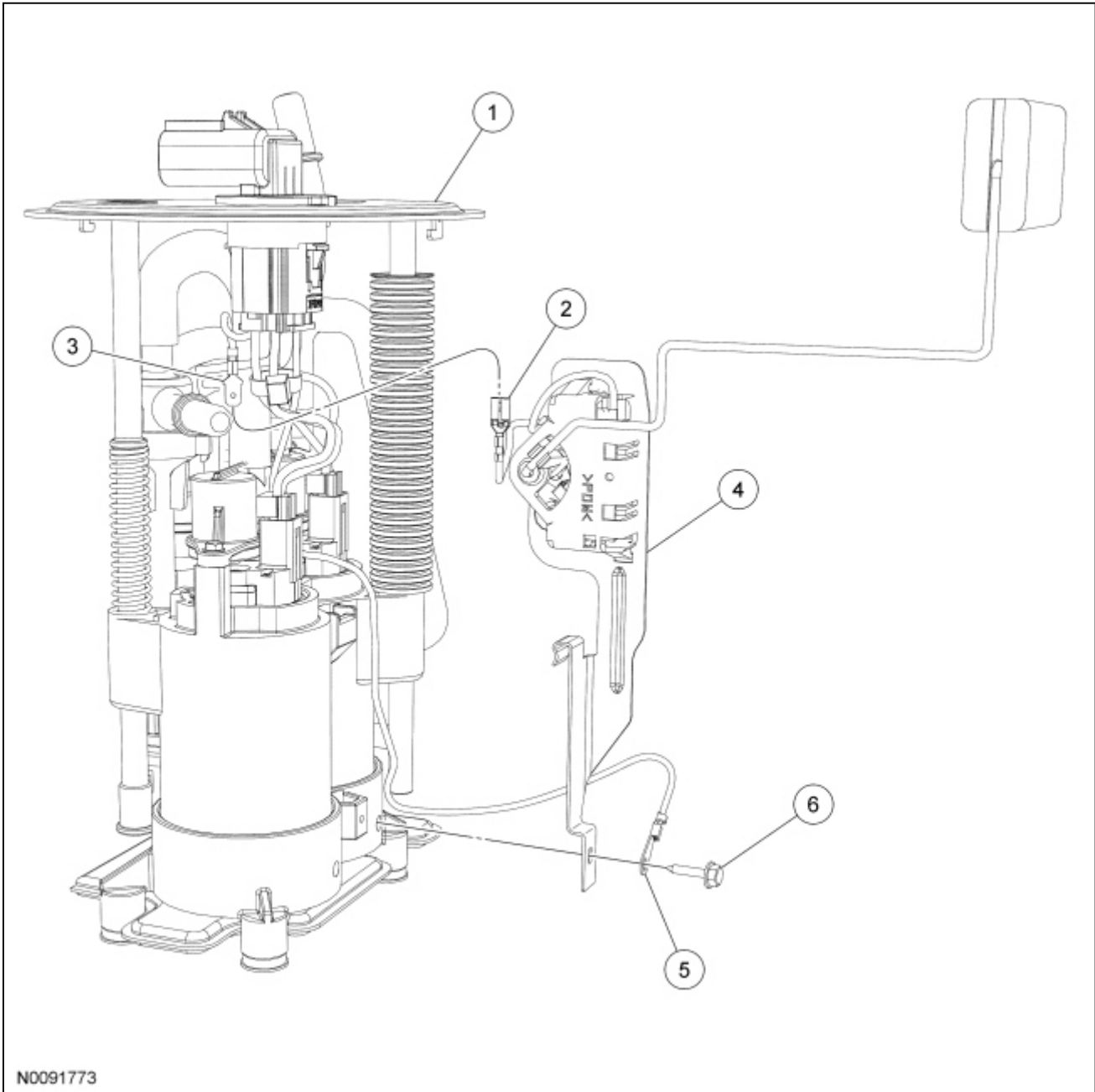

Item	Part Number	Description
1	9H307	Fuel Pump (FP) module
2	—	Fuel level sender electrical connector (part of 9A299)
3	—	Fuel level sender electrical connector (part of 9H307)
4	9A299	Fuel level sender
5	—	Fuel level sender electrical connector eyelets (part of 9H307)
6	—	Fuel level sender screw (part of 9H307)

Removal and Installation

⚠ WARNING: Do not smoke, carry lighted tobacco or have an open flame of any type when working on or near any fuel-related component. Highly flammable mixtures are always present and may be ignited. Failure to follow these instructions may result in serious personal injury.



WARNING: Do not carry personal electronic devices such as cell phones, pagers or audio equipment of any type when working on or near any fuel-related component. Highly flammable mixtures are always present and may be ignited. Failure to follow these instructions may result in serious personal injury.



WARNING: When handling fuel, always observe fuel handling precautions and be prepared in the event of fuel spillage. Spilled fuel may be ignited by hot vehicle components or other ignition sources. Failure to follow these instructions may result in serious personal injury.



WARNING: Always disconnect the battery ground cable at the battery when working on an evaporative emission (EVAP) system or fuel-related component. Highly flammable mixtures are always present and may be ignited. Failure to follow these instructions may result in serious personal injury.

1. Remove the Fuel Pump (FP) module. For additional information, refer to [Fuel Pump Module](#) in this section.
 2. Disconnect the fuel level sender electrical connectors.
 3. Remove the screw, the electrical connector eyelet(s) and remove the fuel level sender from the [FP](#) module.
 4. To install, reverse the removal procedure.
-